



7 Mayne Street North Rothbury, NSW



3



2



2

## IMMACULATE RENOVATION - ?JUST MINUTES FROM THE EXPRESSWAY

?PRINGLE?

7 Mayne Street, North Rothbury

? Freshly renovated family home with beautiful original features.

? Open fire place, high ceilings, decorative cornices, timber floors &

?expansive living & dining areas.

? A generous 810m2 with plenty of room for sheds and a swimming pool.

? 3 large bedrooms upstairs all with built ins and ceiling fans

? Renovated kitchen with adjoining meals/sitting room

? Modern bathroom with bath.

? Downstairs consists of a massive living area opening onto a covered

BBQ area,

? kids play room, office or storeroom

**Scott Bailey**

0407 722 705

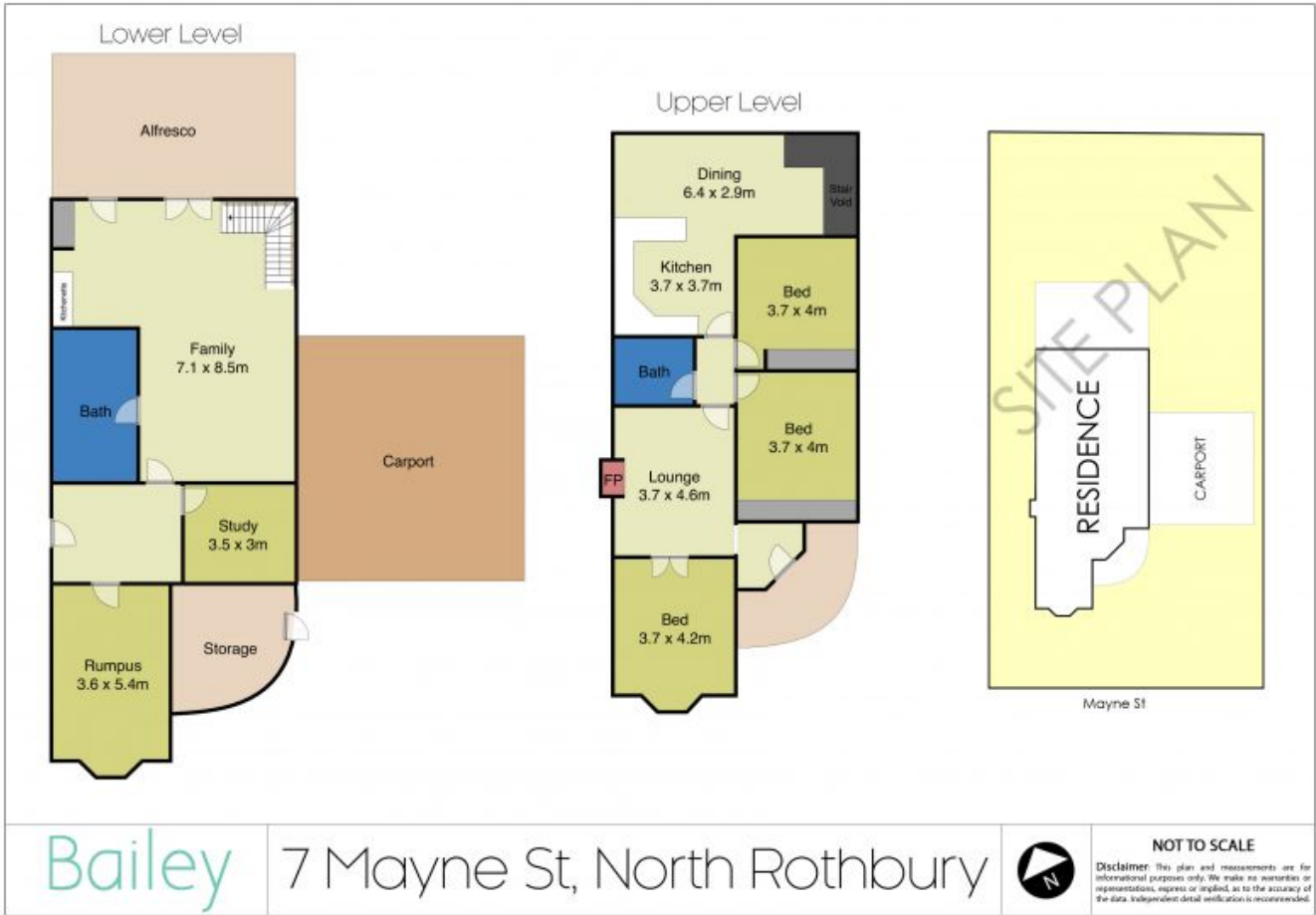

7 Mayne Street

North Rothbury, NSW

Bailey